



Owner's Manual

Model:
Kawasaki Teryx4 750™



Kawasaki Teryx4 750* Windshield Kit

- Safety Instructions
- Kit Contents
- Assembly Instructions

Caution:

Before using this product, read this manual and follow all Safety Instructions.

*DefenderCab™ cabs and accessories are in no way affiliated with Kawasaki Heavy Industries Ltd™. Any use of the name is only to identify their utility vehicle as it pertains to our accessories. Kawasaki and teryx are registered trademarks of Kawasaki heavy industries Ltd.

Warning: Failure to heed all safety and operating instructions and / or warnings regarding use of this product can result in serious bodily injury.

SAFETY INSTRUCTIONS

Read entire assembly instructions before beginning work.

Install all parts indicated in assembly instructions. Failure to fully assemble product before use could result in personal injury.

Assembly of product requires use of hand or power tools. If you are not experienced in using these types of tools, have product dealer do the installation for you.

Some parts contain sharp edges as indicated in the manual. Wear protective gloves if necessary.

Dress for safety. DO NOT wear loose clothing, gloves, neckties or jewelry if using power tools to assemble this product.

Always keep your assembly area clean, uncluttered and well lit.

Keep visitors and children a safe distance away from the assembly area. Visitors should wear the same safety equipment described above.

Windshield Kit Contents

Your DefenderCab™ should contain the parts listed below. Separate all parts from packing materials. Do not discard packing material until assembly is complete. Item quantities are listed in parenthesis below.

Panels.

- (1) Windshield Panel Assembly

Hardware

- (8) 1-3/4" Rubberized Clamp
- (8) #10-32 x 3/4" Screw
- (8) #10-32 Nyloc Nut
- (1) 25ft Roll, Hard Foam Gasket
- (1) 40ft Roll, Soft Foam Gasket
- (12 ft.) Small Protective Edge Trim
- (2) 5/8" Black Plastic Hole Plug
- (6) 1/4" Black Plastic Hole Plug

Tools Required for Assembly

Ensure that you have the following tools available before you begin the assembly of your DefenderCab™ kit. ***Note: Assembly may require assistance.***

- 1/8" Allen key
- 3/8" Wrench / Socket
- Utility knife

Kit Installation

1. Vehicle Preparation

i) Loosely install rubberized clamps onto rollcage at approximate locations shown in (Fig.1). Ensure tabs on panel clamps are pointing towards the interior of the vehicle. (Fig.2)

Fig.1

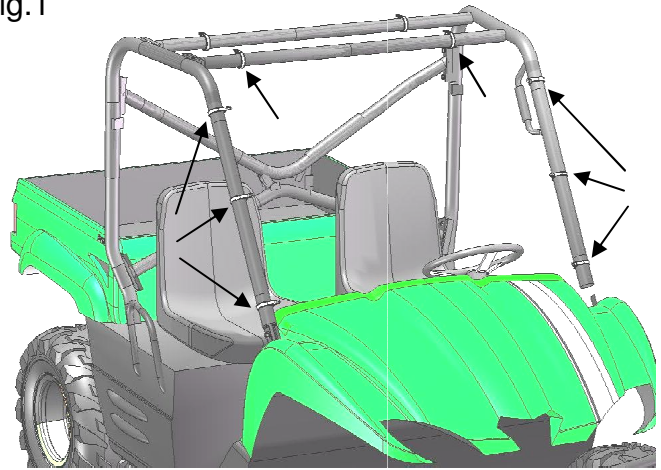
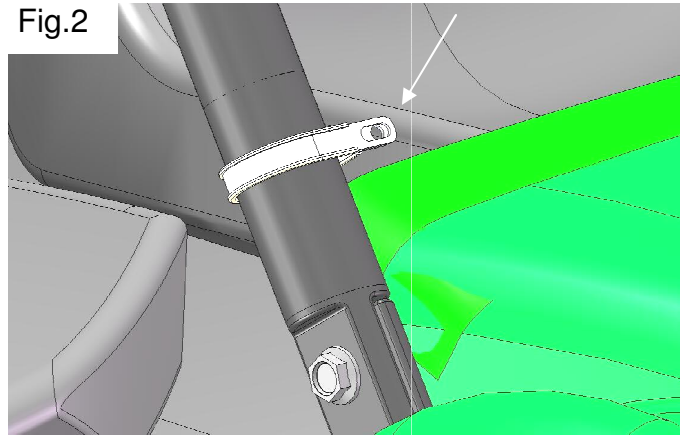
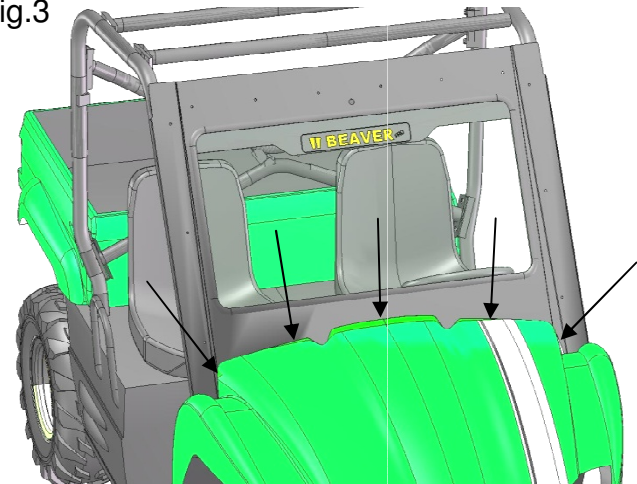

Fig.2



ii) Temporarily install windshield panel onto vehicle; ensure panel is level and aligned identically on both sides of vehicle. Use an erasable marker to transfer bottom edge of panel onto hood surface (Fig.3). Remove panel when done.

Fig.3



2. Installation

iii) Adhere hard foam gasket to top portion of hood using marker line as centerline guide to ensure windshield panel will sit squarely onto foam after installation.

iv) Adhere soft foam gasket on top of hard foam gasket. *(Step not shown)*

v) Install small edge trim completely around side edges of windshield panel and cut to suit. *(Step not shown)*

vi) Re-install windshield panel onto vehicle. Fasten panel with (6) #10-32 3/4" Lg. screws and nyloc nuts (Fig.4) ensuring windshield panel sits firmly onto foam strip.

Fig.4

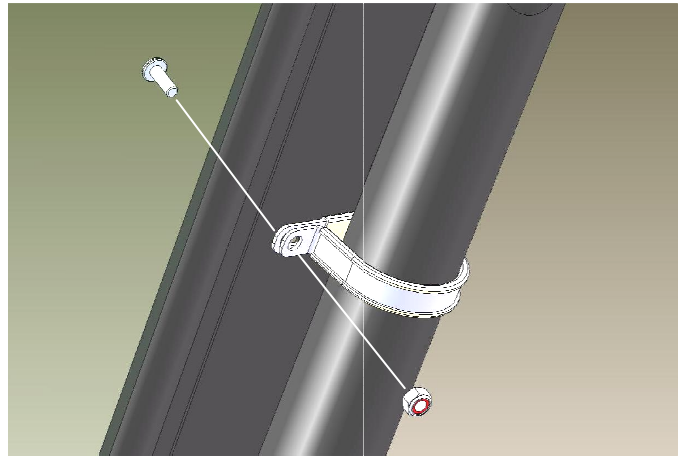

To order replacement parts, contact the Parts Department at:

LB Manufacturing Inc.
247 Arsenault Road,
Dieppe, N.B. Canada
E1A 7J5
Ph: (506) 388-9334 Fax (506) 388-3325
www.defendercab.com
parts@defendercab.com

Manual Revision: 1.0

Date: July 23rd, 2013